

Product Instructions

Viega Motoric Actuator for 1/2" to 1 1/4" Valves

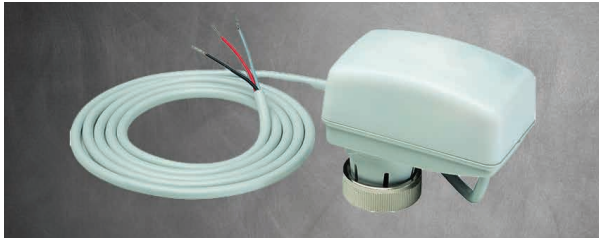

Models 2877.10



Viega LLC
585 Interlocken Blvd.
Broomfield, CO 80021
Phone (800) 976-9819
www.viega.us

EN Product Instructions Viega Motoric Actuator

This document is subject to updates. For the most current Viega technical literature please visit www.viega.us.

PI-MP-PP 531245 0424 Motoric Actuator

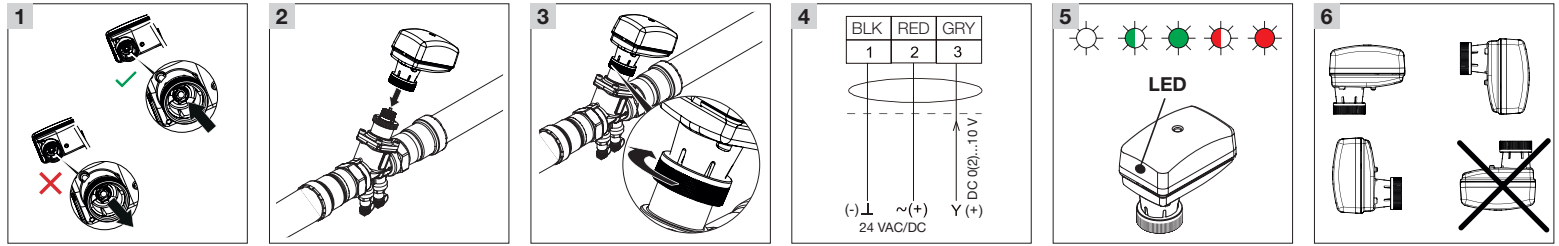

EN

Viega Motoric Actuator for 1/2" to 1 1/4" Valves

For use with Viega ProPress Balancing and Control Valve Models 2981.71 and 2981.72, Viega ProPress Three-Way Valve Model 2976.3, and Viega MegaPress Balancing and Control Valve Models 4881.71 and 4881.72

! Viega products are designed to be installed by licensed and trained plumbing and mechanical professionals who are familiar with Viega products and their installation. **Installation by non-professionals may void Viega LLC's warranty.**

DANGER!
Read and understand all instructions for installing Viega ProPress fittings. Failure to follow all instructions may result in extensive property damage, serious injury, or death.

- 1 Ensure the actuator pin is in the fully retracted position.
- 2 Align actuator with top handle of valve.
- 3 Press actuator onto handle and hand tighten until locked into place. **DO NOT** tighten with a wrench.
- 4 Wiring instructions:
Black: Ground wire
Red: Power wire
Grey: Control wire
- 5 LED lights:

LED Color	Meaning
No light	Off
Half green	Moving to position
Full green	Position reached
Half red	Power on calibration
Full red	Failure signal loss

- 6 Actuator can be oriented in any direction except upside-down.



Calibration is completed automatically. It takes roughly 2 to 3 minutes.



Stroke factory set to 5.5 mm. To adjust, please see the Motoric Actuator Tech Doc.